

EVENT DETAILS

Event: CHOC Cyclation Activation
Venue: Melrose Arch
Date: 15 September 2024
Capacity: 150 bike seats, 900 people
through the day

Times: 08:00 – 18:00
Road: Whiteley Road, Melrose Arch, JHB

SUBMISSION DATE

APPROVAL STAMP(S)

- This map has been approved using Google Earth scales.
- Map is a true reflection of the event as briefed by our client.
- All firefighting equipment has been serviced no more than 12 months before event date

LEGEND

	Emergency assembly
	Event entrance
	Manual hydrant
	5kV ODP substation
	Emergency job
	Emergency exit only
	No parking
	Parking area
	Venue flow
	Evacuation route
	Temporary fencing barrier area outline
	Toilets
	Key security post
	Temp electrical point
	Gas storage area
	Medical
	Food vendor
	Generator
	Distance marker
	2m x 1m tables for promoter permits
	Traffic management signs

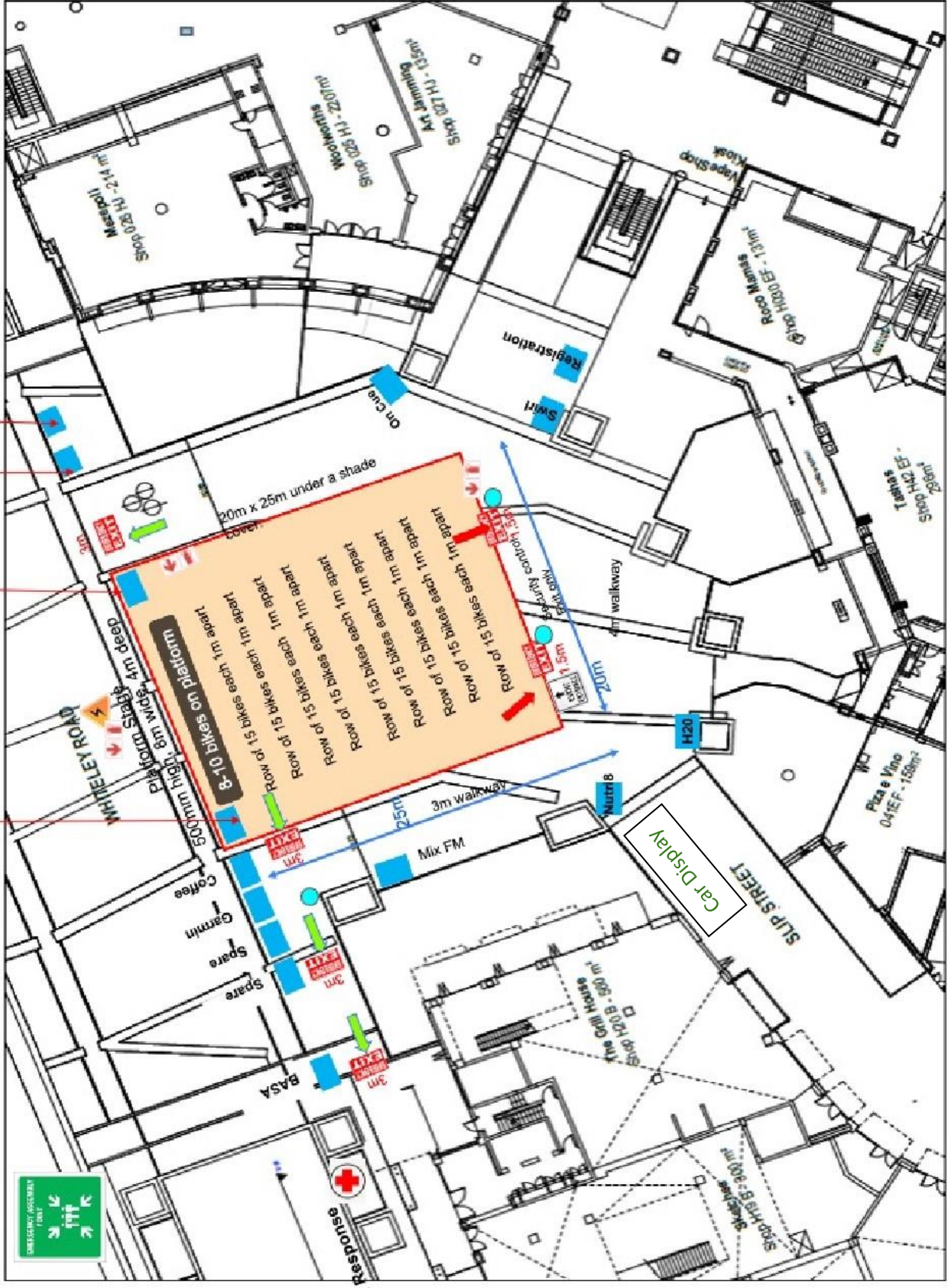

Event space will be under a thin Bedouin tent. See images attached. Bedouin signed off by an engineer
A Stationery cycling charity fundraising event. A six hour event. Each hour / session runs for 50 minutes with a 10 minute change over. Change over of sponsor, spinning instructor and participants. All proceeds go to the charity CHOC
There will be a stage, exercising music, and MC on a mic and a spinning instructor talking through a mic

